

SSB 1201

Room Contents

12 Page & Jolly Chairs
(Copper, Grey & Cyan)

12 Carver Chairs
(Copper & Grey)

4 Circular Coffee Tables

3 Square Meeting Tables

2 Bins

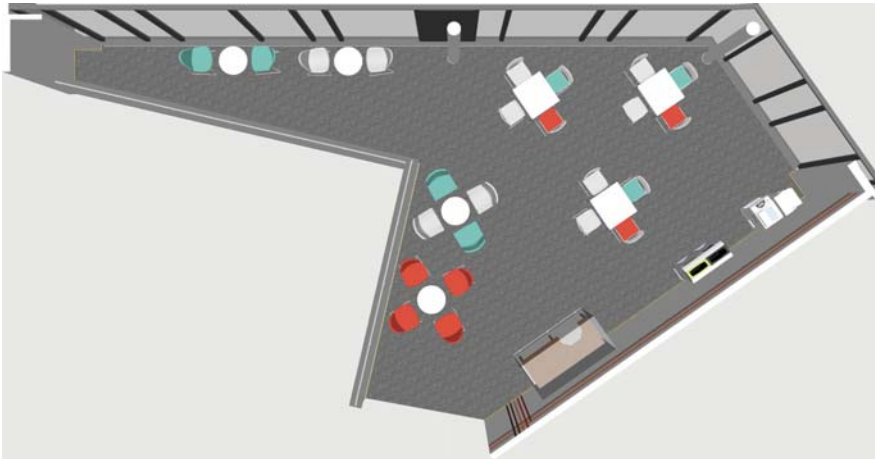

Please

- Move furniture within the room as you wish but return it to the above layout before you leave.
- Don't move furniture between rooms.
- Finish 10 minutes early.
- Turn off the equipment when you leave.
- Take any litter to the nearest bin.

Help and Feedback

Space Management	space@lincoln.ac.uk
Security	01522 88 6062
ICT / AV Support	01522 88 6500 or support.lincoln.ac.uk
Estates Support (Porters/ Cleaning/ Maintenance)	01522 88 6777 or estatessupport@lincoln.ac.uk